

# TANDEM – glijdersysteem

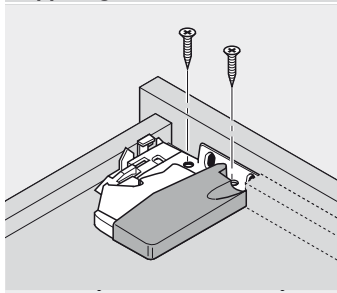

- ▶ TANDEM – basiselement
- ▶▶ Montage, demontage en verstelling

## Koppeling



Vierzijdige lade

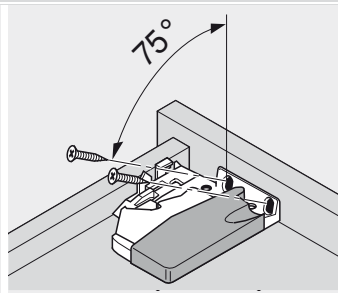

Driezijdige lade

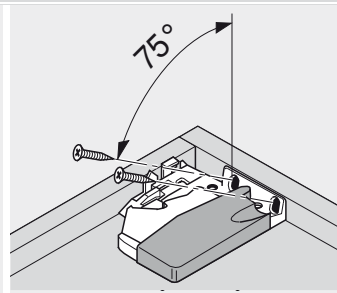

Binnenlade

## Verstelling

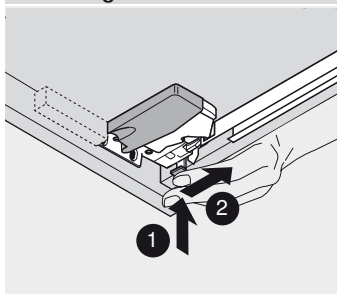

Hoogteverstelling: + 3 mm

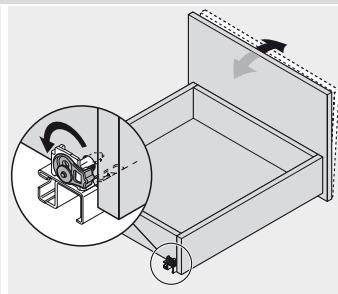

560/566/561: schuine via de glijder

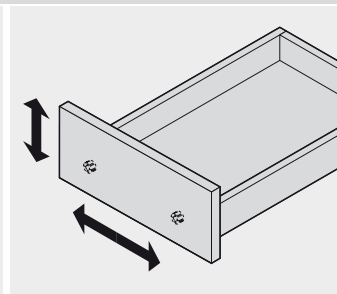

Verstelling hoogte/zijde via frontverstelbeslag ± 2 mm

## Vorraadlade

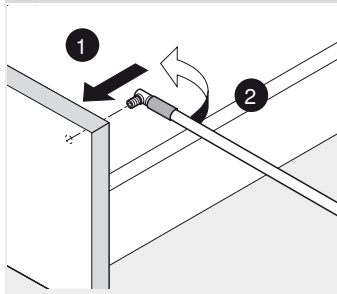

Montage vooraan

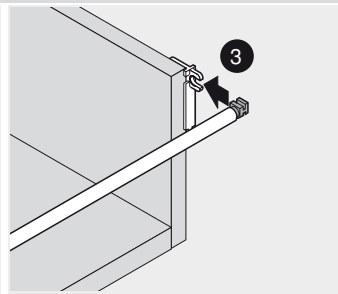

Montage achteraan

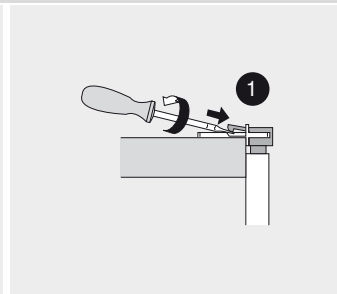

Demontage achteraan

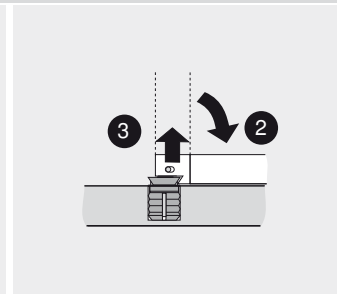

Demontage vooraan

## Lade in- en uithangen (560H/566H/550H)

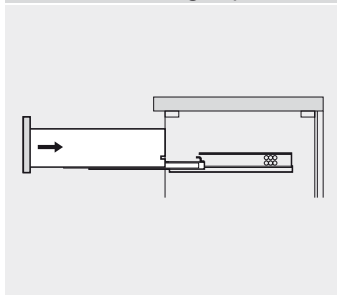

Inhangen

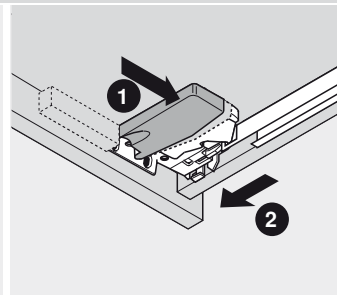
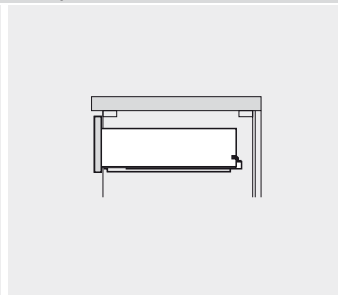

Uithangen

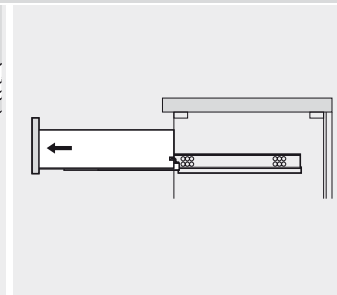



# TANDEM – glijdersysteem

TANDEM – basiselement ◀

Montage, demontage en verstelling ◀◀

## Lade inhangen (561/551H)

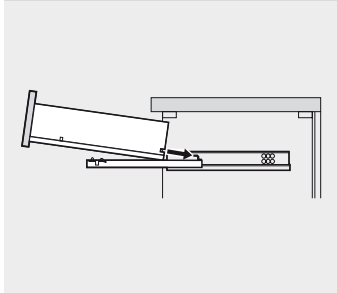

Inhangen

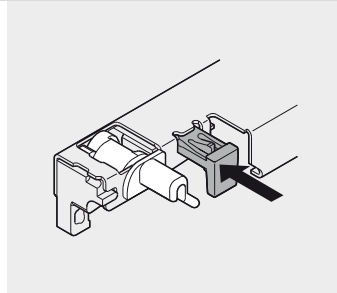
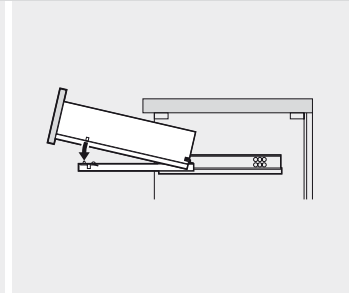

Vergrendelen 561H

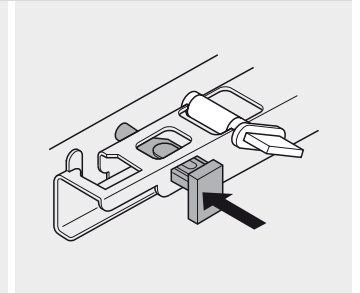

Vergrendelen 551H

## Lade uithalen (561/551H)

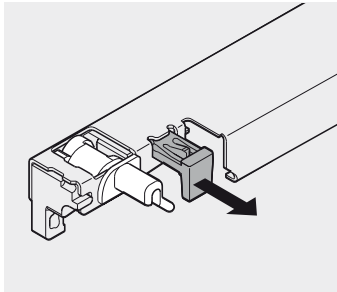

Ontgrendelen 561H

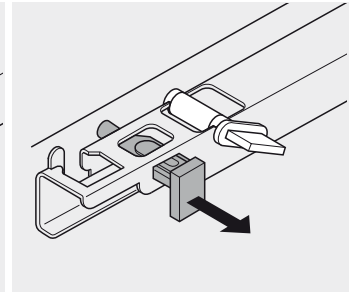

Ontgrendelen 551H

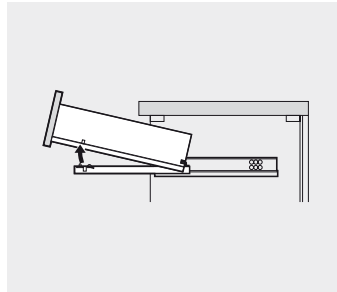

Uithangen

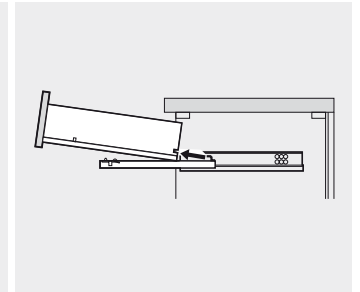

## Hoogteverstelling (561H/551H)

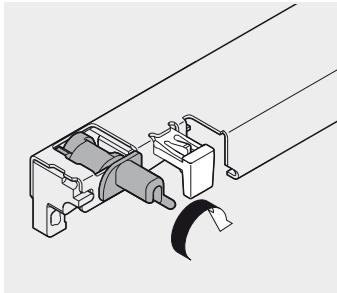

561H: + 2.5 mm

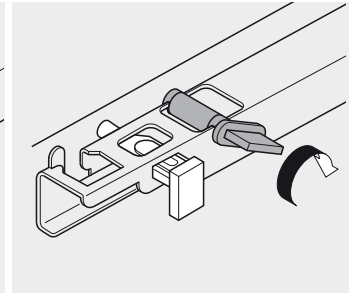

551H: + 2.5 mm

TANDEM

# TANDEM – glijdersysteem



- ▶ TANDEM – basiselement
- ▶▶ Montage, demontage en verstelling

## Frontverstelbeslag

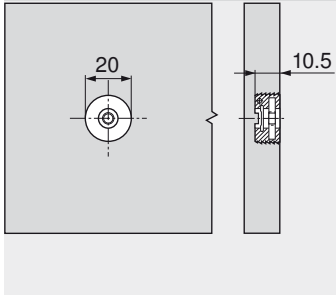

Matrijs voor MINIPRESS +  
PRO-CENTER MZM.0095

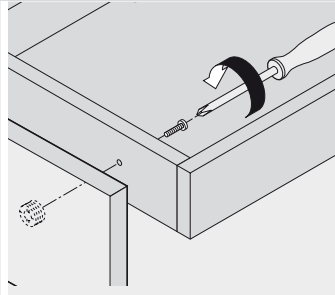
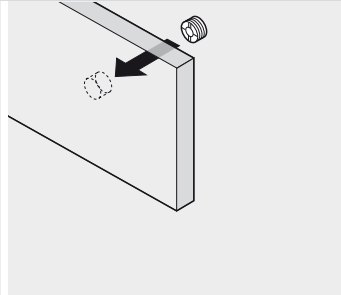

Schroef M4x20 gebruiken

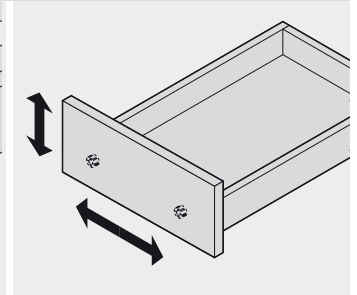

Verstelling hoogte/zijde via frontver-  
stelbeslag  $\pm 2$  mm

## Tablet- en multimedialade

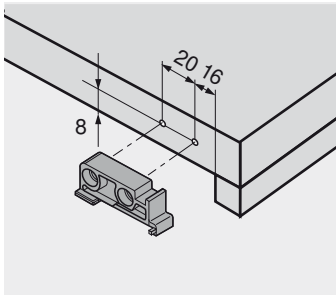

Montage tablethouder

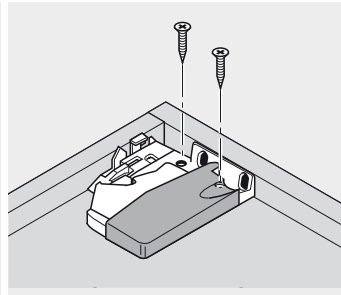

Montage koppeling

## POSISTOP – diepte-aanslag

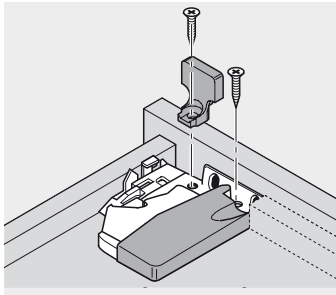

Vierzijdige lade

## Uittrekblokkering

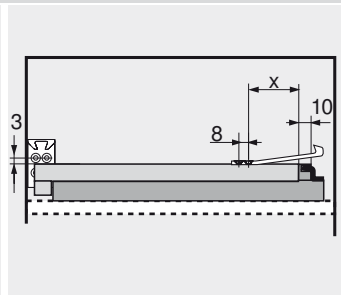
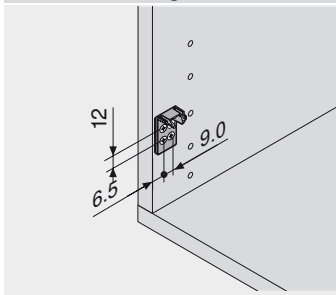

NL	X	X	X	NL	X	X	X
	560H	566H	550H		560H	566H	550H
250	79	-	-	520	80	80	-
270	74	-	134	550	60	80	176
300	74	-	134	580	-	80	-
320	70	-	-	600	80	80	219
350	80	-	134	650	-	80	219
380	82	-	-	700	-	80	-
400	60	-	154	750	-	73	-
420	80	-	-				
450	60	80	154				
480	70	-	-				
500	60	80	176				

NL Nominale lengte